

3250 Covered Hopper Railcar

This 3,250 cubic feet capacity covered hopper railcar has a curve sided design with two compartments and gravity outlet gates specifically designed for sand and cement. This railcar features the robust strength provided by a through center sill and can be furnished lined. This covered hopper comes equipped with three circular hatches and gravity outlet gates. Various roof hatch configurations and outlet gates are available.



THE GREENBRIER COMPANIES

One Centerpointe Drive, Suite 200
Lake Oswego, Oregon 97035

info@gbrx.com

DIMENSIONS (APPROX.)

Length, inside	36'-8 1/8"
Length, over couplers	41'-11 1/2"
Height, inside	N/A
Height, extreme	15'-3"
Clearance	AAR Plate C
Width, inside	N/A
Width, extreme	10'-8"
Door opening, width	N/A
Height, top of rail to threshold	N/A

WEIGHT/CAPACITY (EST.)

Light weight	52,000 lbs.
Load limit	234,000 lbs.
Gross rail load	286,000 lbs.
Capacity	3,250 cu. ft.

CURVE NEGOTIABILITY RADIUS

Uncoupled	150'
Coupled to base car	185'
Coupled to like car	185'

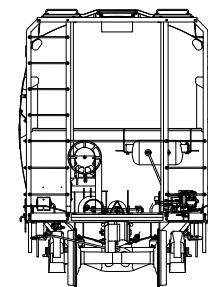
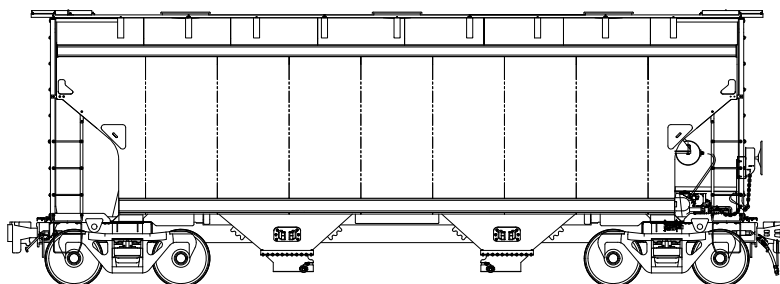
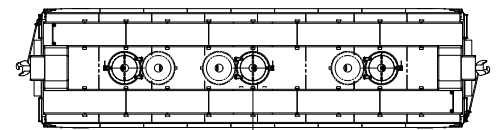

These general dimensions are representative and subject to change without notice.